

TOOLS FOR BASIC MAINTENANCE AND REPAIR

FOR TUBES UP TO 1" I.D.



PSM-500 Easy Handling

Small, straight tubes can often be the source of some not so straight forward problems. Tubes measuring 1" I.D. and smaller can easily trap debris or become clogged from just a minor buildup of deposits. Fortunately, with the PSM-500 Tube Cleaning Drill an in-line water flush makes easy work of removing a wide range of debris, from solid clogs to soft deposits.

After just one cleaning with the PSM-500, you'll be amazed at how easy it is to maintain an optimal tube condition in all of your straight, small tubes.

PSM-500: Tube Cleaning Drill including air drive unit, 15' air hose, 15' water hose, 3/16" or 1/4" starter drill **Call for Price**

Note: See pages 13-14 for accessories.

FEATURES

- Compact, rugged construction
- Independent air motor and water flow controls to reduce water consumption
- Push button trigger to reduce fatigue

**RECOMMENDED
CLEANER
ScaleBreak-5**
Find on pages 48, 166



GTC-705-4



RECOMMENDED

For better air regulation and quality, plus longer motor life, we recommend the combination air lubricator, filter and regulator unit.

GTC-705-4: Combination Air Lubricator, Filter and Regulator (see page 23)..... **Call for Price**

OPTIONAL

3012-500: Carrying Case, with room for up to eight 4' long hollow drills, gun & hoses **Call for Price**

PSM-500

Motor Power	Up to 0.7 HP depending on air pressure and volume
Air Requirements	Minimum 50 PSI at 10.6 CFM, Maximum 90 PSI at 19 CFM
Drill Speed	950 rpm (free speed)
Water Requirements	Minimum 30 PSI at 2 GPM, Maximum 100 PSI at 2 GPM
Hoses	15' air hose and 15' water hose
Dimensions	11 1/4" long
Weight	5 1/2 lbs net dry
Optional Carrying Case	14" high x 53 1/2" wide x 43/4" deep

GOODWAY[®]
INNOVATIVE MAINTENANCE SOLUTIONS

1-800-333-7467

www.goodway.com

420 West Avenue, Stamford, CT 06902-6384 U.S.A. | 203-359-4708 | Fax: 203-359-9601 | goodway@goodway.com

Goodway is not responsible for typographical errors in product descriptions or pricing. Product availability and features may change. Actual products may differ slightly in appearance to images shown. Please contact Goodway with any questions prior to purchase. © Crossford International (2024) All Rights Reserved.

BRUSHES AND CLEANING TOOLS FOR PSM-500

HEAVY DUTY ACCESSORIES FOR SMALL TUBES

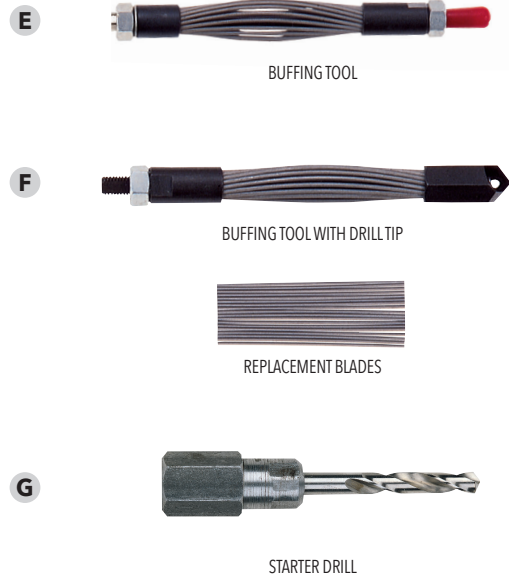
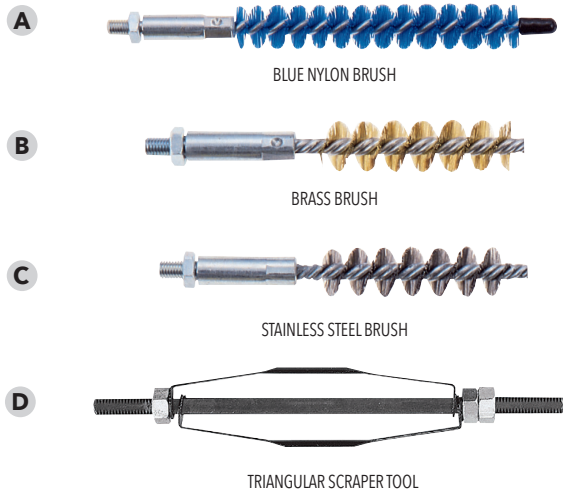

A. BLUE NYLON BRUSHES

Blue Nylon Brushes are recommended for removing soft deposits (mud, algae, etc.) in straight, ferrous and nonferrous tubes.

GTC-211: Blue Nylon Brushes, 1/4", 5/16", 3/8", 7/16", 1/2", 9/16", 5/8", 11/16", 3/4", 13/16", 7/8", 15/16" or 1" **Call for Price**

B. BRASS BRUSHES

Brass Brushes are recommended for removing soft and light scale deposits in straight, ferrous and nonferrous tubes.

GTC-200B: Brass Brushes, 1/4", 5/16", 3/8", 7/16", 1/2", 9/16", 5/8", 11/16", 3/4", 13/16", 7/8", 15/16" or 1" **Call for Price**

C. STAINLESS STEEL BRUSHES

Stainless Steel Brushes are recommended for removing soft and light scale deposits in straight, ferrous tubes.

GTC-210: Stainless Steel Brushes, 1/4", 5/16", 3/8", 7/16", 1/2", 9/16", 5/8", 11/16", 3/4", 13/16", 7/8", 15/16" or 1" **Call for Price**

Note: Blue Nylon, Brass and Stainless Steel Brushes should be equal to or 1/16" smaller than tube I.D.

D. TRIANGULAR SCRAPER TOOLS

Triangular Scraper Tools are used for removing heavy scale deposits in straight, ferrous tubes. They can only be used in a clockwise (forward) direction and cannot be used in internally enhanced tubes. They are adjustable to a 1/4" range.

TST-500: Triangular Scraper Tool for tubes 1/2" - 3/4" I.D. **Call for Price**

TST-500-3: Replacement blade (tool requires Qty 2) **Call for Price**

TST-750: Triangular Scraper Tool for tubes 3/4" - 1" I.D. **Call for Price**

TST-750-3: Replacement blade (tool requires Qty 2) **Call for Price**

E. F. BUFFING TOOLS

Stainless Steel Wire Buffing Tools are used for removing light to medium scale deposits or for finishing tubes previously "roughed out" with other cleaning tools. They can be used in straight, ferrous and nonferrous tubes. Buffing tools can only be used in a clockwise (forward) direction and cannot be used in internally enhanced tubes.

GTC-203P: Buffing Tool for tubes 5/16" - 1/2" I.D. . **Call for Price**

GTC-203PDT: Same as GTC-203 with drill tip.... **Call for Price**

GTC-205: Buffing Tool for tubes 1/2" - 9/16" I.D. . **Call for Price**

GTC-205DT: Same as GTC-205 with drill tip **Call for Price**

GTC-206: Buffing Tool for tubes 5/8" - 1" I.D. **Call for Price**

GTC-206DT: Same as GTC-206 with drill tip **Call for Price**

GTC-207: Replacement Metal Blades for GTC-203P... **Call for Price**

GTC-208A: Replacement Metal Blades for GTC-205. **Call for Price**

GTC-208B: Replacement Metal Blades for GTC-206.. **Call for Price**

G. STARTER DRILLS

Starter Drills are used for making pilot holes in deposits of completely clogged tubes.

GTC-975A: Starter Drill for tubes 3/16"-1/4" I.D. **Call for Price**

GTC-975B: Starter Drill for tubes 3/8" I.D. and up **Call for Price**



1-800-333-7467

www.goodway.com

420 West Avenue, Stamford, CT 06902-6384 U.S.A. | 203-359-4708 | Fax: 203-359-9601 | goodway@goodway.com

Goodway is not responsible for typographical errors in product descriptions or pricing. Product availability and features may change. Actual products may differ slightly in appearance to images shown. Please contact Goodway with any questions prior to purchase. © Crossford International (2024) All Rights Reserved.

BRUSHES AND CLEANING TOOLS FOR PSM-500

DRILLS, SHAFTS, AND CUTTING TOOLS

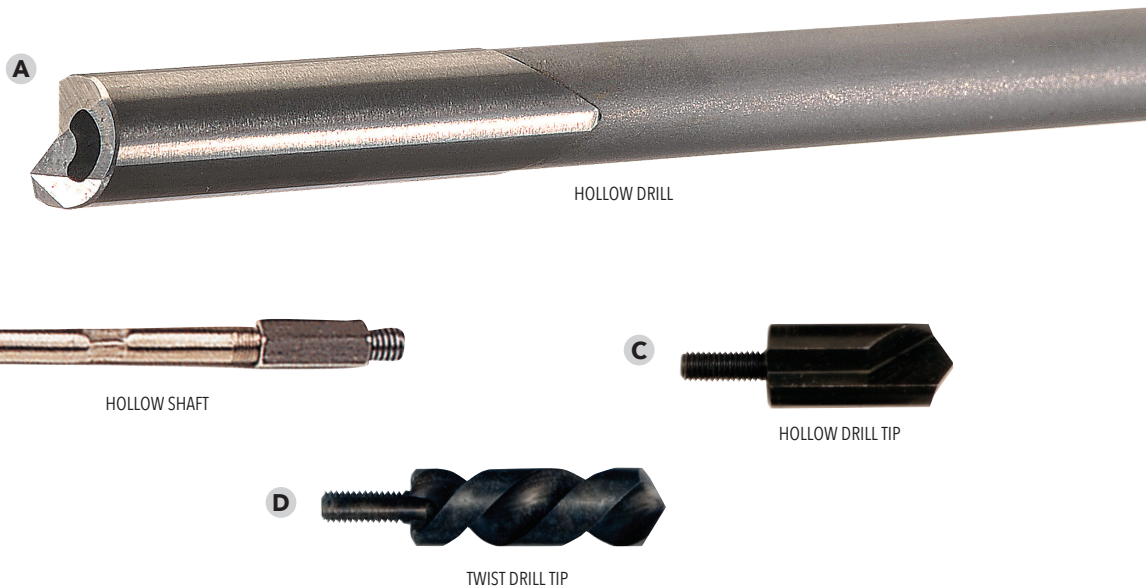

A. HOLLOW DRILLS

Hollow Drills are used for cleaning severely or completely clogged tubes. (Effective length 33" for 3' drills and 45" for 4' drills.)

GTC-960-3: Hollow Drill, 3/16" x 3' **Call for Price**

GTC-961-3: Hollow Drill, 1/4" x 3' **Call for Price**

Note: Hollow Drills are available in diameters from 1/8"-3/4" up to 6' long.

B. HOLLOW SHAFTS

Hollow Shafts adapt brushes, buffing tools, hollow carbide drills and twist drills to PSM-500.

GTC-964-3: Hollow Shaft, 3' long with coupling for 1/4" brushes **Call for Price**

Note: GTC-964 Hollow Shaft is available up to 6' long. To order, change suffix on GTC-964 to length specifications (in feet).

GTC-965-3: Hollow Shaft, 3' long with coupling for 5/16" brushes, coupling for 3/8" brushes, and coupling for 7/16"-1" brushes and all buffing tools for 5/16"-1" I.D. tubes..... **Call for Price**

GTC-965-KIT: Hollow Shaft Kit for tubes 5/16"-1/2" I.D. including three 39" long hollow extension shafts with couplings to form a 10' shaft, a 12" short hollow extension shaft, coupling to connect shaft to PSM-500 and couplings to connect brushes, buffing tools, hollow carbide drills and twist drills to shaft..... **Call for Price**

GTC-989-KIT: Hollow Shaft Kit for tubes 9/16"-1" I.D. including three GTC-998 Hollow Extension Shafts with couplings to form a 10' long shaft, a 1' shaft, coupling to connect shaft to PSM-500, coupling to connect brushes, buffing tools, hollow carbide drills and twist drills to shaft, and assembly tools..... **Call for Price**

GTC-998: Hollow Extension Shaft, 39" long for GTC-989-KIT **Call for Price**

C. HOLLOW DRILL TIPS

Hollow Drill Tips attach to Hollow Shafts and are used to clean severely or completely clogged tubes.

GTC-RWB-031: Hollow Drill Tip, 5/16" **Call for Price**

GTC-RWB-037: Hollow Drill Tip, 3/8" **Call for Price**

GTC-RWB-042: Hollow Drill Tip, 7/16" **Call for Price**

GTC-RWB-050: Hollow Drill Tip, 1/2" **Call for Price**

GTC-RWB-056: Hollow Drill Tip, 9/16" **Call for Price**

GTC-RWB-062: Hollow Drill Tip, 5/8" **Call for Price**

GTC-RWB-075: Hollow Drill Tip, 3/4" **Call for Price**

GTC-RWB-100: Hollow Drill Tip, 1" **Call for Price**

D. TWIST DRILL TIPS

Twist Drill Tips attach to Hollow Shafts and are used to clean severely or completely clogged tubes.

GTC-TD-031: Twist Drills Tip, 5/16" **Call for Price**

GTC-TD-037: Twist Drills Tip, 3/8" **Call for Price**

GTC-TD-042: Twist Drills Tip, 7/16" **Call for Price**

GTC-TD-050: Twist Drills Tip, 1/2" **Call for Price**

GTC-TD-056: Twist Drills Tip, 9/16" **Call for Price**

GTC-TD-062: Twist Drills Tip, 5/8" **Call for Price**

GTC-TD-075: Twist Drills Tip, 3/4" **Call for Price**

GTC-TD-100: Twist Drills Tip, 1" **Call for Price**



1-800-333-7467

www.goodway.com

420 West Avenue, Stamford, CT 06902-6384 U.S.A. | 203-359-4708 | Fax: 203-359-9601 | goodway@goodway.com

Goodway is not responsible for typographical errors in product descriptions or pricing. Product availability and features may change. Actual products may differ slightly in appearance to images shown. Please contact Goodway with any questions prior to purchase. © Crossford International (2024) All Rights Reserved.